



FITTING INSTRUCTIONS FOR FP0189BK FORK PROTECTORS
TRIUMPH BONNEVILLE T120 '16- & STREET TWIN '16-



THIS KIT CONTAINS THE ITEMS PICTURED AND LABELLED BELOW.
DO NOT PROCEED UNTIL YOU ARE SURE ALL PARTS ARE PRESENT.

Please note that the way the kit is packed does not necessarily represent the way of mounting to the bike.

Please note that in cases where kits are packed with a plastic tube separating components on the spindle bar (this tube should be discarded).

THE PARTS SHOWN MAY BE REPRESENTATIVE ONLY (FOR CLARITY OF INSTRUCTIONS ONLY)

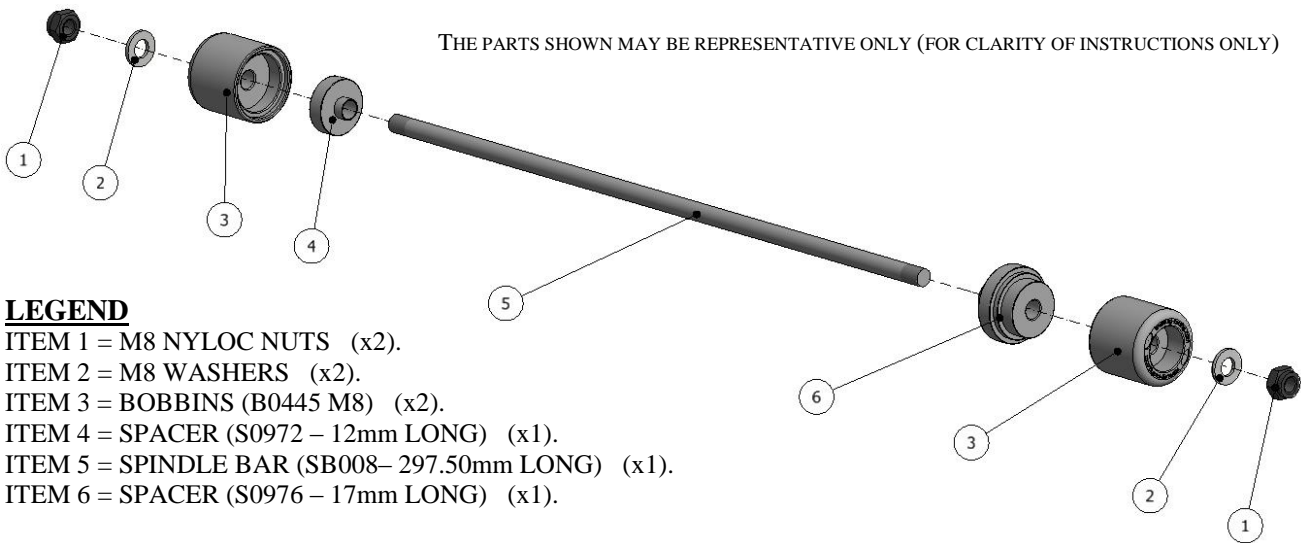

LEGEND

- ITEM 1 = M8 NYLOC NUTS (x2).
- ITEM 2 = M8 WASHERS (x2).
- ITEM 3 = BOBBINS (B0445 M8) (x2).
- ITEM 4 = SPACER (S0972 – 12mm LONG) (x1).
- ITEM 5 = SPINDLE BAR (SB008– 297.50mm LONG) (x1).
- ITEM 6 = SPACER (S0976 – 17mm LONG) (x1).

LEFT HAND SIDE

RIGHT HAND SIDE



TOOLS REQUIRED

- Socket set to include 2x 13mm sockets.

FITTING INSTRUCTIONS

- Fit the longer spacer (S0976 – 17mm long) into the hexagon shaped recess on the right hand side of the front spindle.
- Fit one nut and washer onto the spindle bar (the end with shorter thread) and engage the nut so the plastic insert of the nut is fully engaged.
- Feed the spindle bar (SB008) with nut and washer through either bobbin (B0445 M8) and through the spacer just fitted.
- Place the remaining spacer (S0972 – 12mm long) over the exposed left hand end of spindle bar so the smaller diameter of the spacer fits inside the end of the spindle and then slide the remaining bobbin (B0445 M8) onto the spindle bar.
- Fit the washer and nut from the kit onto the thread and tighten until both nuts are engaged in nylon and equal amounts protrude from either side. Do not overtighten - the nyloc nuts will hold it tight.

ISSUE 1 13/07/2016 (AR)

CONSUMER NOTICE

The catalogue description and any exhibition of samples are only broad indications of the Products and R&G may make design changes which do not diminish their performance or visual appeal and supplying them in such state shall conform to the order. The Buyer acknowledges no representation or warranty (other than as to title) has been given or will apply to the Products other than those in R&G's order or confirmation and the Buyer confirms it has chosen the Products as being of merchantable quality and suitable for its particular purposes. Where R&G fits the Products or undertakes other services it shall exercise reasonable skill and care and rectify any fault free of charge unless the workmanship has been disturbed. The Buyer is responsible for ensuring that the warranty on the motorcycle is not affected by the fitting of the Products. On return of any defective Products R&G shall at its option either supply a replacement or refund the purchase money but shall not be liable if the Products have been modified or used or maintained otherwise than in accordance with R&G's or manufacturer's instructions and good engineering practice or if the defect arises from accident or neglect. Other than identified above and subject to R&G not limiting its liability for causing death and personal injury, it shall not be liable for indirect or consequential loss and otherwise its liability shall be limited to the amounts paid by the Buyer for the Products or the fitting or service concerned. These terms do not affect the Buyer's statutory rights.

R&G RACING RETURNS POLICY (NON-FAULTY GOODS)

Returns must be pre-authorized (if not pre-authorized the return will be rejected). Goods may only be returned direct to us if they were purchased direct from us (customer must prove if necessary). Otherwise to be returned to original vendor. Goods must be in re-sellable condition, in the opinion of R&G Racing. All returns are subject to a 25% restocking and handling fee (25% of the gross value exc. P&P – at the prevailing price at time of purchase). The customer must pay any and all carriage charges. No returns of discontinued products, unless within 14 days of purchase. This policy does not affect your statutory rights and does not refer to faulty goods.



**NOTICE DE MONTAGE POUR FP0189BK PROTECTIONS FOURCHE
TRIUMPH BONNEVILLE T120 '16- & STREET TWIN '16-**

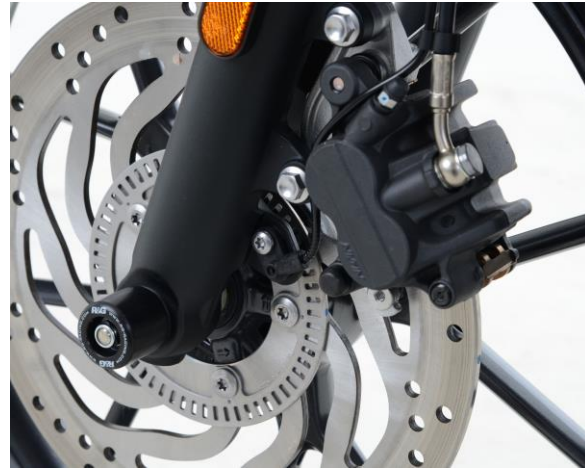

Le kit contient les articles exposés ci-dessous, vérifier que toutes les pièces soient présentes avant de procéder au montage.

LA FAÇON DONT LE KIT EST EMBALLE NE CORRESPOND PAS FORCEMENT A LA FAÇON DE MONTER LES PIÈCES SUR LA MOTO.

Notez que si les kits sont emballés avec un tube en plastic qui sépare les composants sur l'axe, ce tube doit être jeté).

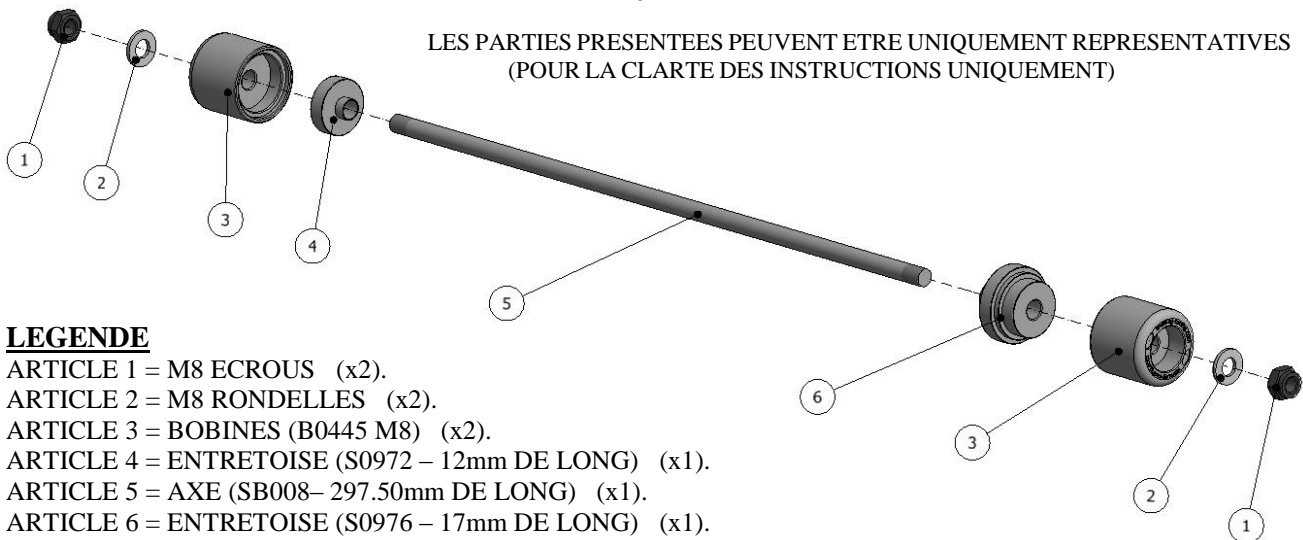

LEGENDE

- ARTICLE 1 = M8 ECROUS (x2).
- ARTICLE 2 = M8 RONDELLES (x2).
- ARTICLE 3 = BOBINES (B0445 M8) (x2).
- ARTICLE 4 = ENTRETOISE (S0972 – 12mm DE LONG) (x1).
- ARTICLE 5 = AXE (SB008– 297.50mm DE LONG) (x1).
- ARTICLE 6 = ENTRETOISE (S0976 – 17mm DE LONG) (x1).

COTE GAUCHE

COTE DROIT



OUTILS REQUIS

- Clé à douille 2x 13mm.

NOTICE DE MONTAGE

- Insérer l'entretoise la plus longue (S0976 – 17mm de long) dans le creux hexagonal du coté droit de l'axe avant.
- Insérer un écrou et une rondelle sur l'axe (l'extrémité avec le filetage le plus court) puis engager l'écrou de façon à ce que l'insert en plastique de l'écrou soit complètement engagé.
- Insérer l'axe (SB008) avec écrou et rondelle dans la protection crash (B0445 M8) puis dans l'entretoise tout juste insérée.
- Placer l'entretoise restante (S0972 – 12mm de long) sur l'extrémité gauche de l'axe de façon à ce que le diamètre le plus petit de l'entretoise se place dans l'extrémité de l'axe puis glisser la bobine restante (B0445 M8) sur l'axe.
- Insérer la rondelle et l'écrou du kit sur le filetage puis serrer jusqu'à ce que les 2 écrous soient engagés dans le nylon et que les longueurs dépassantes de chaque coté soient identiques. **NE PAS TROP SERRER – Les écrous bloquent suffisamment.**

ISSUE 1 13/07/2016 (AR)

CONSUMER NOTICE

The catalogue description and any exhibition of samples are only broad indications of the Products and R&G may make design changes which do not diminish their performance or visual appeal and supplying them in such state shall conform to the order. The Buyer acknowledges no representation or warranty (other than as to title) has been given or will apply to the Products other than those in R&G's order or confirmation and the Buyer confirms it has chosen the Products as being of merchantable quality and suitable for its particular purposes. Where R&G fits the Products or undertakes other services it shall exercise reasonable skill and care and rectify any fault free of charge unless the workmanship has been disturbed. The Buyer is responsible for ensuring that the warranty on the motorcycle is not affected by the fitting of the Products. On return of any defective Products R&G shall at its option either supply a replacement or refund the purchase money but shall not be liable if the Products have been modified or used or maintained otherwise than in accordance with R&G's or manufacturer's instructions and good engineering practice or if the defect arises from accident or neglect. Other than identified above and subject to R&G not limiting its liability for causing death and personal injury, it shall not be liable for indirect or consequential loss and otherwise its liability shall be limited to the amounts paid by the Buyer for the Products or the fitting or service concerned. These terms do not affect the Buyer's statutory rights.

R&G RACING RETURNS POLICY (NON-FAULTY GOODS)

Returns must be pre-authorized (if not pre-authorized the return will be rejected). Goods may only be returned direct to us if they were purchased direct from us (customer must prove if necessary). Otherwise to be returned to original vendor. Goods must be in re-sellable condition, in the opinion of R&G Racing. All returns are subject to a 25% restocking and handling fee (25% of the gross value exc. P&P – at the prevailing price at time of purchase). The customer must pay any and all carriage charges. No returns of discontinued products, unless within 14 days of purchase. This policy does not affect your statutory rights and does not refer to faulty goods.

R&G Racing

Unit 1, Shelley's Lane, East Worldham, Alton, Hampshire, GU34 3AQ

Tel: +44 (0)1420 89007 Fax: +44 (0)1420 87301 www.rg-racing.com Email: info@rg-racing.com